

## DS-8104/8108/8116HWI-ST 960H Standalone DVR

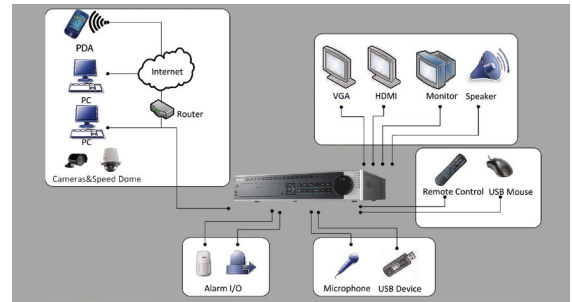

### Key features

- H.264 video compression
- WD1(PAL:960×576,NTSC:960×480) resolution real-time recording
- HDMI and VGA output at up to 1920×1080P resolution
- Dual-stream
- 4/8/16-ch synchronous playback
- HDD quota and group management

### Rear Panel of DS-8116HWI-ST

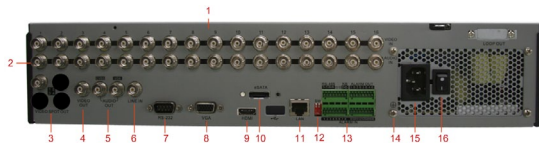

1. Video in
2. Audio in
3. Video spot out
4. Video out
5. Audio out
6. Line in
7. RS-232 serial interface
8. VGA interface
9. HDMI interface
10. eSATA interface
11. LAN interface
12. Termination switch
13. RS-485 serial interface, keyboard interface, alarm in, alarm out
14. GND
15. 100~240 VAC power input
16. Power switch

### Specifications

|                             | DS-8104HWI-ST                                                                                   | DS-8108HWI-ST              | DS-8116HWI-ST               |
|-----------------------------|-------------------------------------------------------------------------------------------------|----------------------------|-----------------------------|
| <b>Video / Audio input</b>  |                                                                                                 |                            |                             |
| Video compression           | H.264                                                                                           |                            |                             |
| Analog video input          | 4-ch,                                                                                           | 8-ch                       | 16-ch                       |
|                             | BNC(1.0Vp-p, 75 Ω), PAL/NTSC self-adaptive                                                      |                            |                             |
| Audio compression           | OggVorbis                                                                                       |                            |                             |
| Audio input                 | 4-ch, BNC (2.0 Vp-p, 1 kΩ)                                                                      | 8-ch, BNC (2.0 Vp-p, 1 kΩ) | 16-ch, BNC (2.0 Vp-p, 1 kΩ) |
| Voice talk input            | 1-ch, BNC (2.0 Vp-p, 1 kΩ)                                                                      |                            |                             |
| <b>Video / Audio output</b> |                                                                                                 |                            |                             |
| HDMI/ VGA output            | 1024×768 /60 Hz, 1280×720 /60 Hz,1280×1024 /60 Hz, 1600×1200 /60 Hz, 1920×1080P /60 Hz          |                            |                             |
| CVBS output                 | 2-ch, (1 Main output+ Spot output), BNC (1.0Vp-p, 75Ω), resolution: PAL: 704×576, NTSC: 704×480 |                            |                             |
| Video loop out              | Reserved                                                                                        |                            |                             |
| Audio output                | 2-ch, BNC                                                                                       |                            |                             |
| Encoding resolution         | Main stream: WD1 / 4CIF / 2CIF / CIF / QCIF, Sub-stream: CIF/QCIF                               |                            |                             |
| Frame rate                  | 25fps (P) / 30fps (N)                                                                           |                            |                             |
| Video bit rate              | 32 Kbps-8 Mbps, or user defined                                                                 |                            |                             |
| Audio bit rate              | 16 Kbps                                                                                         |                            |                             |
| Dual-stream                 | Support                                                                                         |                            |                             |
| Stream type                 | Video, Video & Audio                                                                            |                            |                             |
| Playback resolution         | WD1 / 4CIF / 2CIF / CIF / QCIF                                                                  |                            |                             |
| Synchronous playback        | 4-ch                                                                                            | 8-ch                       | 16-ch                       |
| <b>Hard disk</b>            |                                                                                                 |                            |                             |
| SATA                        | Up to 8 SATA interfaces                                                                         |                            |                             |
| eSATA                       | 1 eSATA interface                                                                               |                            |                             |
| Capacity                    | Up to 4TB capacity for each disk                                                                |                            |                             |
| <b>External interface</b>   |                                                                                                 |                            |                             |
| Network interface           | 1, RJ45 10M/100M/1000M adaptive Ethernet                                                        |                            |                             |
| Serial interface            | RS-232 interface; RS-485 interface;keyboard;                                                    |                            |                             |
| USB interface               | 2 x USB2.0                                                                                      |                            |                             |
| Alarm in                    | 4                                                                                               | 16                         | 16                          |
| Alarm out                   | 2                                                                                               | 4                          | 4                           |
| <b>General</b>              |                                                                                                 |                            |                             |
| Power supply                | AC 220V, 47-63 Hz                                                                               |                            |                             |
| Consumption                 | ≤35W                                                                                            | ≤40W                       | ≤45W                        |
| Working temperature         | -10°C ~ +55°C (14°F ~ 131°F)                                                                    |                            |                             |
| Working humidity            | 10% ~ 90%                                                                                       |                            |                             |
| Chassis                     | 19-inch rack-mounted 2U chassis                                                                 |                            |                             |
| Dimensions (W × D × H)      | 445 × 470 × 90 mm                                                                               |                            |                             |
| Weight                      | ≤ 8Kg (without hard disk or DVD-R/W)                                                            |                            |                             |