

### Installation Instructions

Part Number: RG522

- 1.** Remove test box cover and test switch.

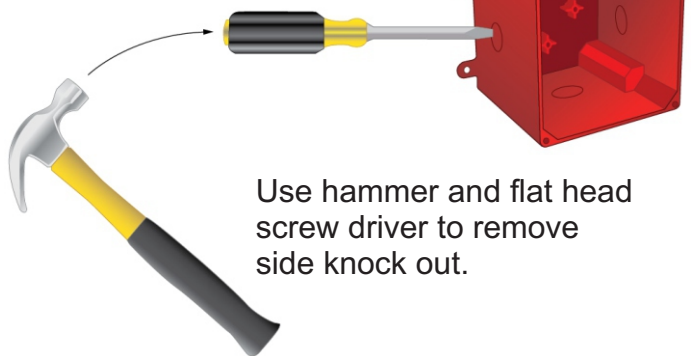

- 2.**

Install strain relief connector through knock out.

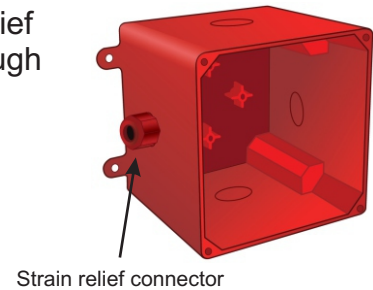

- 3.** Strip the insulation off the end of the LHD cable and attach to test switch in either polarity. Also connect EOL resistor to test switch.

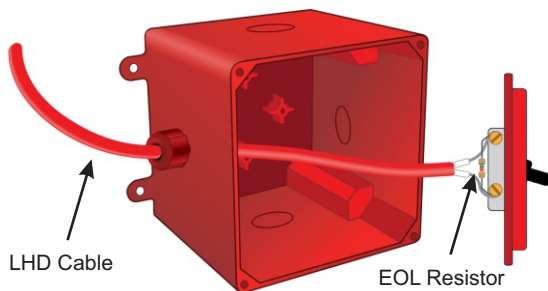

- 4.** Reinstall test switch and test box cover.



**NOTE:** CAN BE ORIENTATED EITHER WAY, HAS TWO 1/2" KNOCKOUTS AND TWO 3/4" KNOCKOUTS.

**Note:** Please refer to all federal, state and local codes, and manufacturer's recommendations prior to design or installation.