



**Safety Technology  
International**

# 4-Channel Voice Receiver

STI-V34104



## **EASY STARTUP**

Install batteries in sensor,  
plug in receiver and listen  
to instructions.

## **HOW THE PRODUCT WORKS**

The 4-Channel Voice Receiver is a multipurpose long-range receiver that works with a wide range of STI Wireless Alert Series sensors. Most products can achieve up to 1,000' receiver range (line of site). Four zone indicators light up to indicate a sensor has triggered. Selectable tones and voice messages are a key feature. Sensors have default messages or program your own by choosing up to four words or tones from a preprogrammed list. All voice messages are available in English or Spanish. Receiver is intended for indoor use only.

**Rely on STI®**

## BEFORE YOU START

Review detailed product specifications (Fig. 1 and 2)

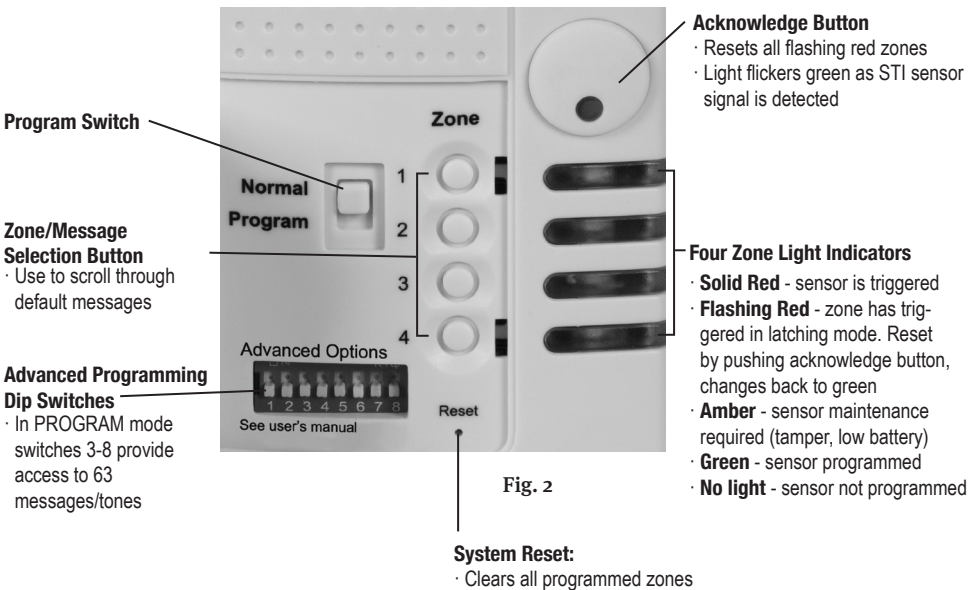
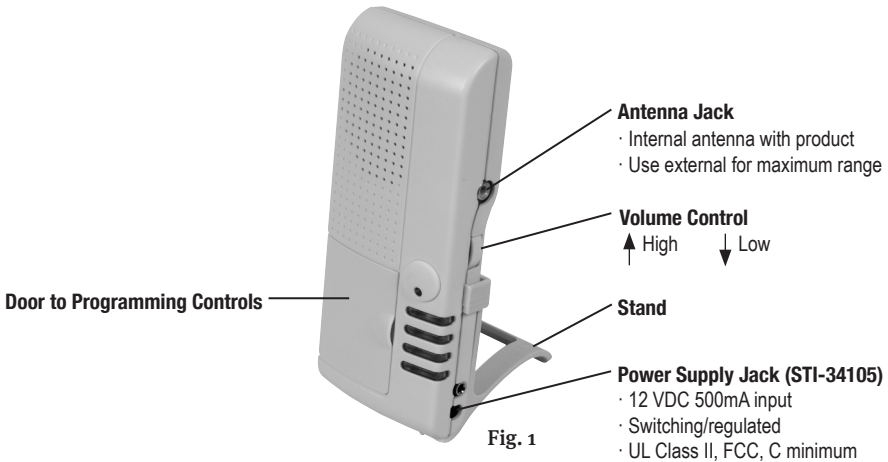

## ZONE PROGRAMMING PROCEDURES

Only receives wireless signals from the *STI Wireless Alert Series* products. Program up to 4 sensors or keyfobs. Does not allow programming into an **occupied** zone. Cannot program the **same sensor** into more than one zone. The unit will state, "Please change to normal mode if programming is completed." (Repeats every 60 seconds.) Default language is English. Move dip switch 1 to the "on" (up) position for Spanish.

## MODES OF OPERATION

Set at time of programming by zone

### Zone Latching: Dip Switch #2 'OFF'

When sensor is triggered, red zone light is solid. "Latching" let's you know a zone was triggered, but the alert has cleared (flashing red LED). To reset, push the acknowledge button.

### Zone Auto Restore: Dip Switch #2 'ON'

"Auto-Restore" sounds when a zone has been triggered. Zone automatically restores to solid green light without pressing acknowledge button.

## Dip Switch Functions

DIP SWITCH	NORMAL MODE		PROGRAM MODE	
	OFF (DOWN)	ON (UP)	OFF (DOWN)	ON (UP)
1	—		ENGLISH*	SPANISH
2	—		LATCHING*	AUTO RESTORE
3	PRE-ALERT TONE*	NO TONE	TONE/WORD SELECT	
4	—		TONE/WORD SELECT	
5	—		TONE/WORD SELECT	
6	—		TONE/WORD SELECT	
7	—		TONE/WORD SELECT	
8	—		TONE/WORD SELECT	

**\*Default Mode**

CHART 1

## PROGRAMMING

1. Plug in receiver.
2. Listen to verbal voice commands. They will guide you through programming.

### Notes

- Firmly press acknowledge button at any time to stop voice.
- Make sure battery is installed in sensor.
- Each sensor provides an initial sound (DONG).  
(See CHART 2 below)
- Each zone button, with programmed sensor, scrolls through default messages using the zone/message selection button.
- Accept tone/message selected by moving switch to NORMAL mode. These can be changed at any time by moving the switch to PROGRAM and pushing the zone/message selection button.

## SCROLLING MESSAGE/TONES - Default messages by sensor type

Universal Garage Sentry Mailbox Alert	Doorbell Button	Driveway Monitor	Entry Alert®	Indoor and Outdoor PIR	Exit/Fire Extinguisher Stopper	Stopper Station Stopper Station Shield
Mailbox	Call	Front Driveway	Front Door Alert	Motion Front	Emergency Door Alert	Assistance
Door	Alert	Side Driveway	Side Door Alert	Motion Side	Front Extinguisher Alert	Alert
Gate	Assistance	Rear Driveway	Rear Door Alert	Motion Rear	Side Extinguisher Alert	Protective Cover
Window	Service	No Sound*	Exit Door Alert	Motion Driveway	Rear Extinguisher Alert	No Sound*
Cover	Door	Ding	Gate Alert	Motion Upstairs	Assistance	Ding
Garage Sentry	Customer	Ding Dong	Dock Alert	Motion Downstairs	Extinguisher	Ding Dong
Temperature	No Sound*	Dong	No Sound*	Customer	Side	Dong
Sump Pump	Ding	4-Note Chime	Ding	Ding	Hall	4-Note Chime
Freezer	Ding Dong	8-Note Chime	Ding Dong	Ding Dong	No Sound*	8-Note Chime
Refrigerator	Dong	Knock	Dong	Dong	Ding	Knock
Water Level	4-Note Chime	Bell	4-Note Chime	4-Note Chime	Ding Dong	Jingle Bells
No Sound*	8-Note Chime	Buzzer	8-Note Chime	8-Note Chime	Dong	Dogs Barking
Ding	Knock		Knock	Knock	4-Note Chime	Bell
Ding Dong	Jingle Bells		Jingle Bells	Bell	8-Note Chime	Buzzer
Dong	Dogs Barking		Dogs Barking	Buzzer	Knock	
4-Note Chime	Bell		Bell		Jingle Bells	
8-Note Chime	Buzzer		Buzzer		Dogs Barking	
Knock					Bell	
Jingle Bells					Buzzer	
Dogs Barking						
Bells						
Buzzer						

\*Zone light indicator still operates

CHART 2

# ADVANCED PROGRAMMING FOR ALREADY PROGRAMMED SENSORS (DIP SWITCH 3-8)

Dip Switches 3-8 provide access to all 63 messages/tones which can be assigned to any zone. Up to 4 messages/tones can be combined to create a custom message. See page 6, CHART 3, for Advanced Dip Switch Message Codes.

## ADVANCED PROGRAMMING

1. Make sure switch is in PROGRAM mode
2. Press zone/message selection button intended for sensor advanced programming
3. Move Dip Switches to correct position for selected word
4. Press zone/message selection button to accept word (repeat for up to four words/tones)

**⚠ CAUTION – while selecting custom message do not position all Dip Switches back into OFF (down) position. This will reset your entire message!**

5. Move switch to NORMAL mode when complete
6. Test/trigger sensor

**Note:** If you make a mistake while programming zone custom message, press acknowledge button to revert to previous message then begin again.

## Example of Advanced Programming Message

“(Ding Dong) Customer Service Alert” Four Step Programming

### VIEW DIP SWITCH CONTROLS

**STEP 1**

	0	0	0	0	1	0	Message Code
MESSAGE:							ON (UP)
DING DONG							OFF (DOWN)
	3	4	5	6	7	8	Dip Switch

Press Zone/Message Selection Button

**STEP 2**

	0	1	1	1	1	0	Message Code
MESSAGE:							ON (UP)
CUSTOMER							OFF (DOWN)
	3	4	5	6	7	8	Dip Switch

Press Zone/Message Selection Button

**STEP 3**

	0	1	1	1	1	1	Message Code
MESSAGE:							ON (UP)
SERVICE							OFF (DOWN)
	3	4	5	6	7	8	Dip Switch

Press Zone/Message Selection Button

**STEP 4**

	0	1	1	0	1	0	Message Code
MESSAGE:							ON (UP)
ALERT							OFF (DOWN)
	3	4	5	6	7	8	Dip Switch

Press Zone/Message Selection Button

### CREATE YOUR OWN CUSTOM MESSAGE

MESSAGE CODE

MESSAGE

-----

MESSAGE CODE

MESSAGE

-----

MESSAGE CODE

MESSAGE

-----

MESSAGE CODE

MESSAGE

-----

# ADVANCED DIP SWITCH MESSAGE CODES

ALPHABETICAL (ENGLISH)							
DIP SWITCH		LANGUAGE					
3	4	5	6	7	8	English	Spanish
0	0	0	1	0	0	4-NOTE CHIME	CARILLON DE 4 NOTAS
0	0	0	1	0	1	8-NOTE CHIME	CARILLON DE 8 NOTAS
0	1	1	0	1	0	ALERT	ALERTA
0	1	1	0	1	1	ASSISTANCE	ASISTENCIA
1	1	0	0	0	1	BARN	GRANERO
1	0	1	0	1	1	BASEMENT	SOTANO
0	0	1	0	0	1	BELL	CAMPANA
1	1	0	1	1	1	BUTTON	BOTON
0	0	1	0	1	0	BUZZER	ZUMBADOR
0	1	0	0	1	1	CABINET	GABINETE
0	1	1	0	0	1	CALL	LLAMADA
1	1	0	1	0	1	CLOSE	CERRAR
1	0	0	0	0	0	COVER	CUBIERTA
0	1	1	1	1	0	CUSTOMER	CLIENTE
1	0	1	1	1	0	DECK	TERRAZA
0	0	0	0	0	1	DING	TIMBRE (DIN)
0	0	0	0	1	0	DING-DONG	DIN-DON
1	0	0	0	0	1	DOCK	MUELLE
0	0	1	0	0	0	DOGS	PERROS
0	0	0	0	1	1	DONG	TIMBRE (DON)
0	0	1	1	1	0	DOOR	PUERTA
1	0	1	0	1	0	DOWNSTAIRS	ABAJO
0	1	0	0	0	1	DRIVEWAY	ENTRADA
0	1	1	0	0	0	EMERGENCY	EMERGENCIA
0	1	0	1	1	1	EXIT	SALIDA
0	1	0	1	1	0	EXTINGUISHER	EXTINTOR DE INCENDIOS
1	1	1	1	1	1	FOUR	CUATRO
1	0	0	1	1	0	FREEZER	CONGELADOR
0	0	1	0	1	1	FRONT	FRENTE
1	0	1	1	0	1	GARAGE	GAREJE
0	0	1	1	1	1	GATE	ENTRADA
1	1	0	0	1	1	GUN	PISTOL
1	1	0	0	0	0	HALL	EL PASILLO
0	0	0	1	1	1	JINGLE BELLS	CASCABEL
0	1	1	1	0	0	KEYFOB	LLAVERO
1	0	1	1	0	0	KITCHEN	COCINA
0	0	0	1	1	0	KNOCK	LLAMADA A LA PUERTA
1	1	1	0	0	0	LIQUOR	LICOR
0	1	0	0	1	0	MAILBOX	BUZON DE CORREO
1	1	0	0	1	0	MEDICINE	MEDICINA
0	1	0	1	0	1	MONITOR	MONITOR
1	1	1	0	0	1	MOTION	MOVIMIENTO
1	1	1	1	0	0	ONE	UNO
1	1	0	1	0	0	OPEN	ABIERTA
1	0	1	1	1	1	PATIO	PATIO
1	0	0	0	1	0	POOL	PISCINA
1	1	1	0	1	1	PRE-ALERT	PRE-AVISO
1	1	1	0	1	0	PROTECTIVE COVER	CUBIERTA
PROTECTORA							
0	0	1	1	0	1	REAR	TRASERA
1	0	0	1	1	1	REFRIGERATOR	REFRIGERADOR
0	1	0	1	0	0	SAFE	CAJA FUERTE
0	1	1	1	1	1	SERVICE	SERVICIO
1	0	0	0	1	1	SHED	COBERTIZO
0	0	1	1	0	0	SIDE	LADO
1	0	0	1	0	1	SUMP PUMP	POZO DE BOMBEO
1	0	1	0	0	0	TEMPERATURE	LA TEMPERATURE
0	1	1	0	1	1	THEFT	ROBO
1	1	1	1	1	0	THREE	TRES
1	1	0	1	1	0	TROUBLE	PROBLEMAS
1	1	1	1	0	1	TWO	DOS
1	0	1	0	0	1	UPSTAIRS	ARRIBA
1	0	1	0	0	0	WATER LEVEL	NIVEL DEL AGUA

GROUPINGS								
DIP SWITCH		LANGUAGE						
3	4	5	6	7	8	English	Spanish	GROUP
0	0	0	1	0	0	4-NOTE CHIME	CARILLON DE 4 NOTAS	TONES
0	0	0	1	0	1	8-NOTE CHIME	CARILLON DE 8 NOTAS	
0	0	1	0	0	1	BELL	CAMPANA	
0	0	1	0	1	0	BUZZER	ZUMBADOR	
0	0	0	0	0	1	DING	TIMBRE (DIN)	
0	0	0	0	1	0	DING-DONG	DIN-DON	
0	0	1	0	0	0	DOGS	PERROS	
0	0	0	0	1	1	DONG	TIMBRE (DON)	
0	0	0	1	1	1	JINGLE BELLS	CASCABEL	
0	0	0	1	1	0	KNOCK	LLAMADA A LA PUERTA	
1	1	0	0	0	1	BARN	GRANERO	LOCATIONS
1	0	1	0	1	1	BASEMENT	SOTANO	
1	0	1	1	1	0	DECK	TERRAZA	
0	1	0	0	0	1	DRIVEWAY	ENTRADA	
1	0	0	0	0	1	DOCK	MUELLE	
1	0	1	0	1	0	DOWNSTAIRS	ABAJO	
0	0	1	0	1	1	FRONT	FRENTE	
1	0	1	1	0	1	GARAGE	GAREJE	
1	1	0	0	0	0	HALL	EL PASILLO	
1	0	1	1	0	0	KITCHEN	COCINA	
1	0	1	1	1	1	PATIO	PATIO	ALERTS
1	0	0	1	0	1	POOL	PISCINA	
0	0	1	0	1	0	REAR	TRASERA	
1	0	0	1	1	1	SHED	COBERTIZO	
0	0	1	1	0	0	SIDE	LADO	
1	0	1	0	0	1	UPSTAIRS	ARRIBA	
0	1	1	0	1	0	ALERT	ALERTA	
0	1	1	0	1	1	ASSISTANCE	ASISTENCIA	
0	1	1	0	0	1	CALL	LLAMADA	
1	1	0	1	0	1	CLOSE	CERRAR	
0	1	1	1	1	0	CUSTOMER	CLIENTE	
0	1	1	0	0	0	EMERGENCY	EMERGENCIA	
0	1	0	1	1	1	EXIT	SALIDA	
0	1	0	1	1	0	EXTINGUISHER	EXTINTOR DE INCENDIOS	
0	1	0	1	0	1	MONITOR	MONITOR	
1	1	1	0	0	1	MOTION	MOVIMIENTO	
1	1	0	1	0	0	OPEN	ABIERTA	
1	1	1	0	1	1	PRE-ALERT	PRE-AVISO	
0	1	1	1	1	1	SERVICE	SERVICIO	
1	0	0	1	0	0	TEMPERATURE	LA TEMPERATURE	
0	1	1	0	1	1	THEFT	ROBO	
1	1	0	1	1	0	TROUBLE	PROBLEMAS	
1	0	1	0	0	0	WATER LEVEL	NIVEL DEL AGUA	
1	1	0	1	1	1	BUTTON	BOTON	OBJECTS
0	1	0	0	1	1	CABINET	GABINETE	
1	0	0	0	1	0	COVER	CUBIERTA	
0	0	1	1	0	0	DOOR	PUERTA	
1	0	0	1	1	0	FREEZER	CONGELADOR	
0	0	1	1	1	1	GATE	ENTRADA	
1	1	0	0	1	1	GUN	PISTOL	
0	1	1	1	0	0	KEYFOB	LLAVERO	
1	1	1	0	0	0	LIQUOR	LICOR	
0	1	0	0	1	0	MAILBOX	BUZON DE CORREO	
1	1	0	0	1	0	MEDICINE	MEDICINA	
1	1	1	0	1	0	PROTECTIVE COVER	CUBIERTA	
PROTECTORA								
1	0	0	1	1	1	REFRIGERATOR	REFRIGERADOR	
0	1	0	1	0	0	SAFE	CAJA FUERTE	
1	0	0	1	0	0	SUMP PUMP	POZO DE BOMBEO	
0	1	0	0	0	0	WINDOW	VENTANA	
1	1	1	1	0	0	ONE	UNO	
1	1	1	0	0	1	TWO	DOS	

CHART 3

## **DELETE SENSOR**

1. In PROGRAM mode simultaneously press and hold the acknowledge button and zone/message selection button for three seconds.
2. Successful when receiver states, "Zone [number] is empty," and green LED is off.

## **LOW BATTERY / TAMPER / OUT OF RANGE ALERT**

The 4-Zone LED light indicator will turn yellow when maintenance is required on your sensor (example: low battery or tampering with a sensor). The LED will remain on until the trouble condition is cleared and a transmission is received. When replacing the battery in a sensor, you will not need to reprogram into the receiver.

## **MOUNTING OPTIONS**

The receiver can be mounted on a wall or set on a table with the provided stand.

## **WARRANTY INFORMATION**

Safety Technology International, Inc. warrants to the **original** consumer/purchaser that this product shall be free of defects in material and workmanship under normal use and circumstances for a period of one (1) year from the original date of purchase.

Electronic warranty form at [www.sti-usa.com/wc14](http://www.sti-usa.com/wc14).

## IMPORTANT NOTICE

This product has been tested and complies with the specifications for a Class B digital device, pursuant to Part 15 of the FCC Rules. These limits are designed to provide reasonable protection against harmful interference in a residential installation. This equipment generates, uses, and can radiate radio frequency energy and, if not installed and used according to the instructions, may cause harmful interference to radio communications. However, there is no guarantee interference will not occur in a particular installation. If this equipment does cause harmful interference to radio or television reception, which is found by turning the equipment off and on, the user is encouraged to try to correct the interference by one or more of the following measures:

- Reorient or relocate the receiving antenna.
- Increase the separation between the equipment and devices.
- Connect the equipment to an outlet other than the receiver's.
- Consult a dealer or an experienced radio/TV technician for assistance.

Operation is subject to the following two conditions: (1) this device may cause interference, and (2) this device must accept interference, including interference that may cause undesired operation of the device. Changes or modifications not expressly approved by Safety Technology International, Inc. could void your authority to operate this equipment.

To reduce potential radio interference to other users, the antenna type and its gain should be so chosen that the equivalent isotropically radiated power (e.i.r.p.) is not more than that permitted for successful communication.

This product meets the applicable industry Canada Technical specifications.

Le présent matériel est conforme aux spécifications techniques applicables d'Industrie Canada.

Model: STI-V34104  CAN ICES-3 (B)/NMB-3(B)

This device is a wireless receiver intended for home and office use in all EU and EFTA member states.

## TECHNICAL SUPPORT

Contact STI at 248-673-9898

## ADDITIONAL WIRELESS ALERT SERIES PRODUCTS

<b>STI-34099</b>	Single Channel Slave Receiver	<b>STI-6200WIR</b>	Wireless Fire Extinguisher Theft Stopper
<b>STI-V34104</b>	4-Channel Voice Receiver	<b>STI-6200WIR4</b>	Wireless Fire Extinguisher Theft Stopper w/Receiver
<b>STI-34108</b>	8-Channel Receiver	<b>STI-6400WIR</b>	Wireless Exit Stopper Door Alarm
<b>STI-34101</b>	Solar Powered Driveway Monitor Sensor	<b>STI-6400WIR4</b>	Wireless Exit Stopper Door Alarm with Receiver
<b>STI-34151</b>	Battery Powered Driveway Monitor Sensor	<b>STI-6517A</b>	Stopper Station Shield with Sound
<b>STI-34201</b>	Wireless Mail Alert Sensor	<b>STI-6517B</b>	Stopper Station Shield with Sound and Transmitter
<b>STI-34301</b>	Wireless Garage Sentry Sensor	<b>STI-30105</b>	Extended Antenna
<b>STI-34401</b>	Wireless Universal Alert Sensor	<b>STI-34105</b>	Voltamax 12VDC (500mA) Power Supply
<b>STI-34501</b>	Wireless Door Entry Alert® Sensor	<b>STI-34106</b>	Keyfob
<b>STI-34601</b>	Wireless Doorbell Button	<b>STI-34188</b>	8-Zone Relay Board



USA



**Safety Technology  
International**

2306 Airport Rd • Waterford, MI 48327, USA

Phone: 248-673-9898 • [info@sti-usa.com](mailto:info@sti-usa.com) • [www.sti-usa.com](http://www.sti-usa.com)

Taylor House • 34 Sherwood Road • Bromsgrove, Worcestershire • B60 3DR • England  
Tel: +44 (0)1527 520 999 • [info@sti-emea.com](mailto:info@sti-emea.com) • [www.sti-emea.com](http://www.sti-emea.com)

Unit 7A • Lockhead Avenue • Airport Business Park • Waterford • X91 HWF2 • Ireland  
[info@sti-emea.com](mailto:info@sti-emea.com) • [www.sti-emea.com](http://www.sti-emea.com)



EMEA