

Intelligent lock(five in one) operation manual

- 2) Voice prompt in network configuration mode: press "1" for hotspot connection and "2" for intelligent connection.
- 3) When the network is successfully added, the 1st, 2nd, 3rd and 4th lights on the keyboard will be on in order with a voice prompt of "operation completed".
- 4) In the event of network addition failure, the 1st, 2nd, 3rd and 4th lights on the keyboard will not be on and there will be a voice prompt of "operation failed" upon timeout.

Notice:

Please add administrator before setting.

9. Other notes

- 1) Input the wrong password more than 5 times in a row, the keyboard locked for 30 seconds, it does not respond to any operations in 30 seconds.
- 2) Password peeping prevention function: input password as follows when opening the door with password: XXX password XXX; you can add some extraneous codes before and after the password, and then press # to confirm. The password must be included in the input contents.
- 3) If there is no operation more than 10 seconds, system will automatically exit.
- 4) After the voltage is lower than 4.6v, the lock will automatically alarm every time when it is opened. After the alarm, the lock can be opened for about 200 times.
- 5) Remove the battery cover,press the "Set" key for 6 seconds,the lock was restored to factory mode;
- 6) In factory mode,input "333666999#" can change the language quickly;
- 7) When unlocking,input "5#"to enter passage mode(One time effective);
- 8) When unlocking,input "*"to broadcast the user number;

Technical Parameters

| Technical Parameters | | | |
|----------------------|--|--------------------------------|------|
| | Items | Parameters | Memo |
| 1 | Static current | ≦ 50uA | |
| 2 | Dynamic current | ≦ 180mA | |
| 3 | Administrators number | 9 | |
| 4 | Fingerprint number | 100 | |
| 5 | Fingerprint + password + card capacity | 300 | |
| 6 | Fingerprint Sensor | Semiconductor | |
| 7 | Fingerprint contrast time | ≦ 0.6Second | |
| 8 | Fingerprint identification Angle | 360° | |
| 9 | False Rejection Rate | ≦ 0.1% | |
| 10 | False Recognition Rate | ≦ 0.0001% | |
| 11 | Reaction time | ≦ 0.1 Second | |
| 12 | Power type | 6V | |
| 13 | Emergency power | 5VDC | |
| 14 | Working temperature | -25℃~60℃ | |
| 15 | Working Relative Humidity | 20%~90%RH | |
| 16 | Human voice | Yes | |
| 17 | Keyboard | Touch standard 12-bit keyboard | |
| 18 | Password Length | 4-8 digits | |
| 19 | Phantom password | 32 digits | |
| 20 | Low voltage alarm | 4.6±0.2V | |
| 21 | Unlock time | ≦ 1Second | |

FINGERPRINT DOOR LOCK



user manual

INSTALLATION GUIDE

Accessory

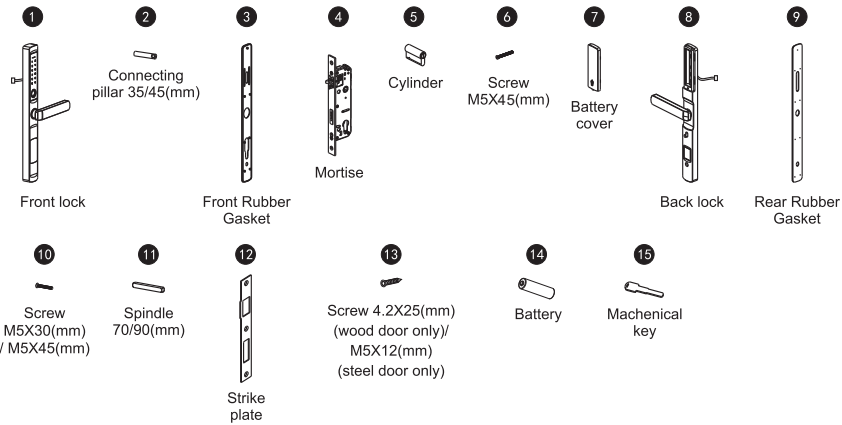

Door opening direction

① Right handle opening

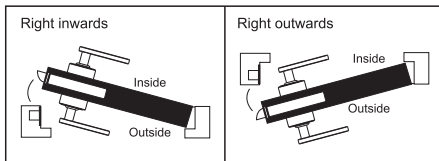

② Left handle opening

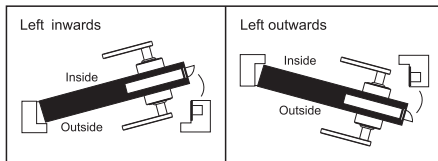

Adjust the mortise direction

According to the your need to adjust the mortise direction.

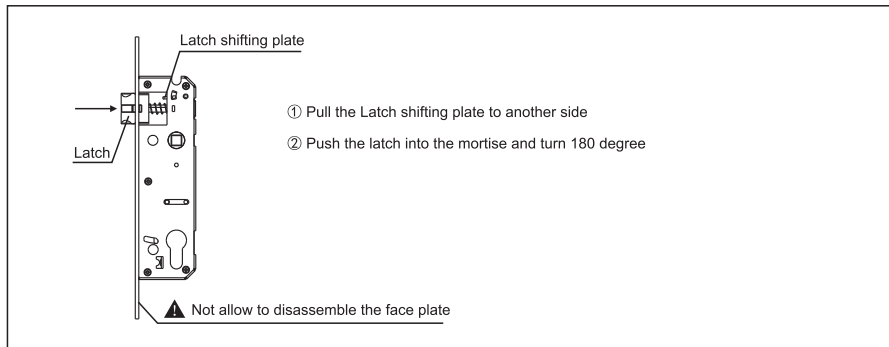

Switch Left Handle and Right handle

According to your opening direction, loose the screw inside the handle with a Philip screw driver, and pull out the handle, then turn to the correct direction that you want, then fix the screw inside the handle.

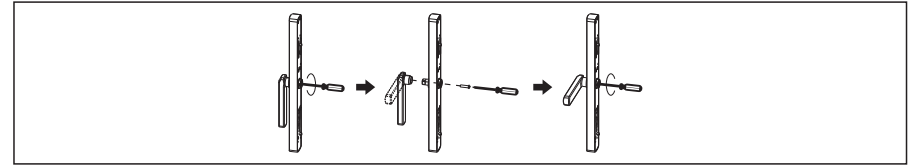

Right Handle

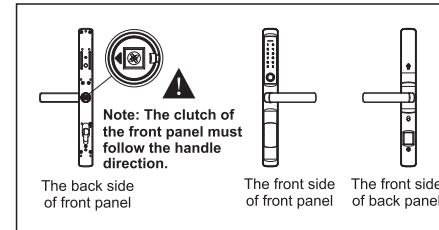

Left Handle

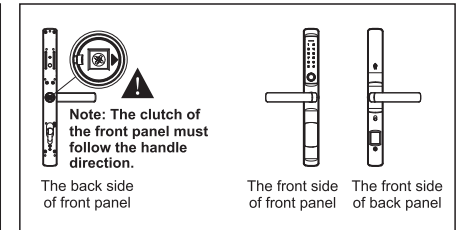

Accessories for sorts of door thickness

Available door thickness 35mm-70mm. If the door is over this range, please contact us for more information. Please select the correct accessories according to your door thickness.

| Code and name | Specifications(mm) | door thickness ranges & QTY | |
|-------------------------------------|--------------------|-----------------------------|-----------|
| | | 35-50(mm) | 50-70(mm) |
| ① Spindle 70/90(mm) | 70 | 1 | |
| | 90 | | 1 |
| ⑬ Screw 4.2X25(mm) (wood door only) | 25 | 5 | 5 |
| | 4.2 | | |
| ⑬ Screw M5X12(mm) (steel door only) | 12 | 5 | 5 |
| | M5 | | |
| ⑩ Screw M5X30(mm) / M5X45(mm) | 30 | 1 | |
| | M5 | | |
| | 45 | 1 | 2 |
| ② Connecting pillar 35/45(mm) | 35 | 2 | |
| | 45 | | 2 |

Caution before installation

- ① Do not be a strong force when installation, avoid to damaging the lock.
- ② Use correct installation tools.
- ③ Wear glass to protect your eyes when drilling holes.
- ④ Drilling the door holes on both side of the door avoiding to damaging the door plate.

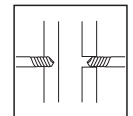
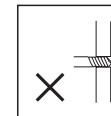
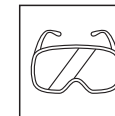
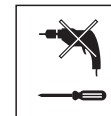
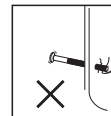

Installation

Installation steps:

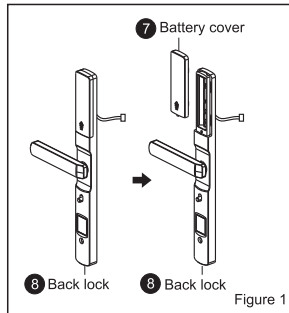

- (1) As Figure 1:
① Divide the Back Lock into Battery cover and Back panel.

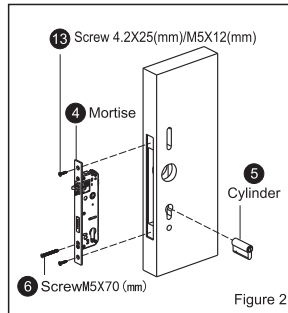

- (2) As Figure 2:
① Make the mortise cable get through the door plate, fix the mortise with 2 screws.

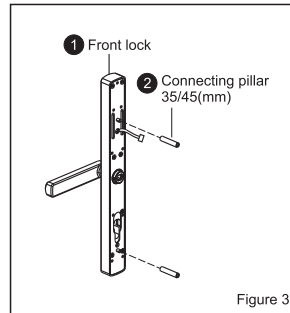

- (3) As Figure 3:
① Install the two connecting pillars with the front lock.

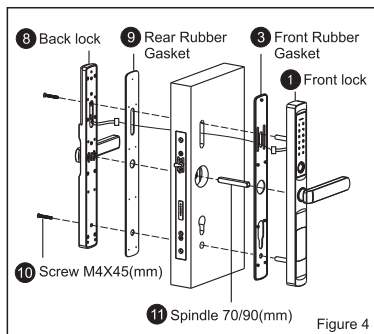

- (4) As Figure 4:
① Insert the spindle into mortise.
② Make the front body cable through the front rubber gasket, door plate and rear rubber gasket, can connect to the rear body.
③ Fix the rear body and front body with two screws.

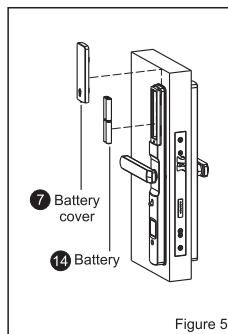

- (5) As Figure 5:
① Put the Batteries correctly and fix the Battery cover.

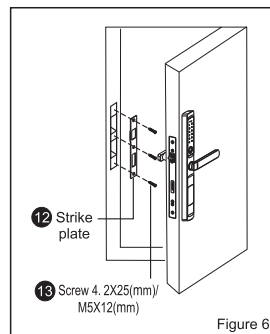

- (6) As Figure 6:
① Fix the fix the strike plate with 3 screws on the door frame.

Check points after installation

- ① The face plate is horizontal with the door.
- ② The Latch bolt and Dead bolt must works smoothly and flexibly.
- ③ The Front lock is vertical and stable.
- ④ Front handle works smoothly and flexibly, Dead bolt should be in position when you lift the handle.
- ⑤ Dead bolt should be in position when you lift the Back handle, and it should be retracted when you press the handle.

Intelligent lock(five in one) operation manual

1.Function and Operation

1.1 Description of terms and functional keys

1) Administrator information: refer to the Administrator's fingerprint, password or IC card.
Unlock information: refer to the input fingerprint, password, Remote control or IC card information (including Administrator and ordinary users).

2) Key"*": clear key/back key. Enter the password or point by clearing the previous input. Press the clear key three times in succession, empty all input.

3) Key"#": confirmation key or menu function key.

2. Original state

1) The factory administrator orinital password is 123456, under the orinital state any fingerprint, IC card or password can open the lock.

2) Any fingerprint, IC card, or password which are not registered can't open the lock after inputting the administrator information.

3. Lock function management (step one)

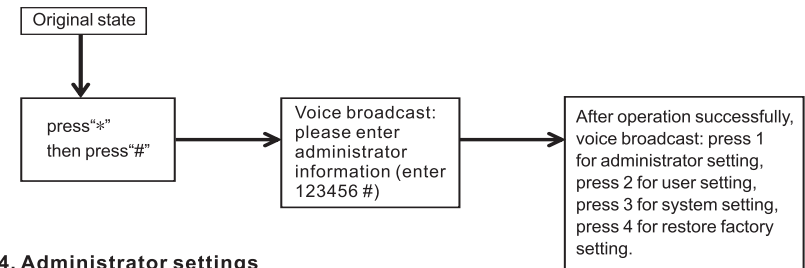

4. Administrator settings

1) Add administrator (step 2)

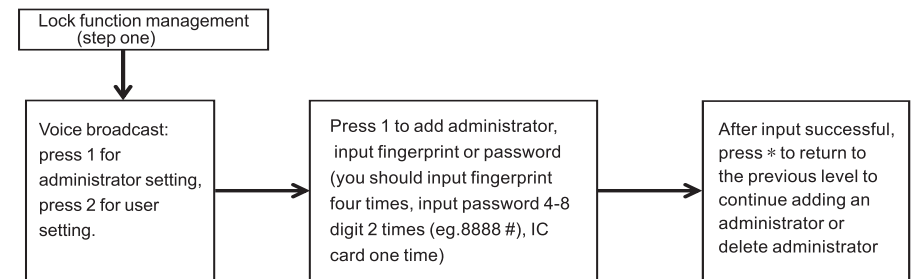

2) Delete administrator information

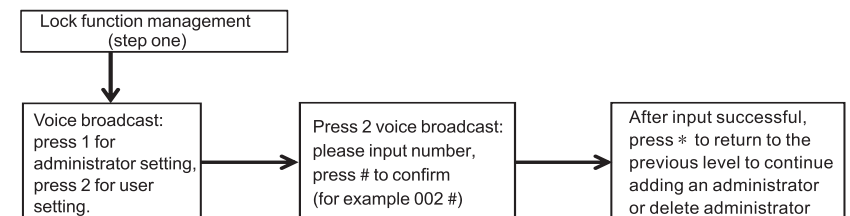

5. Common user setting

1) Add User information

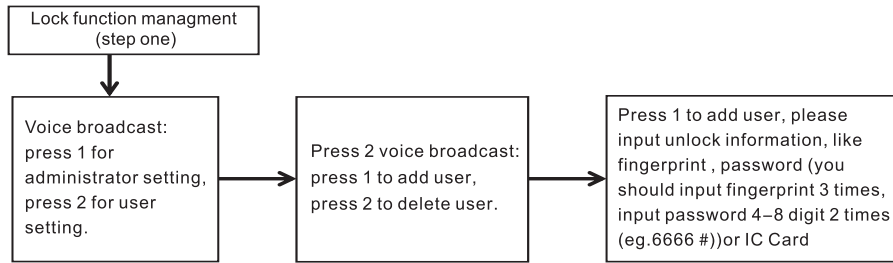

2) Delete user information

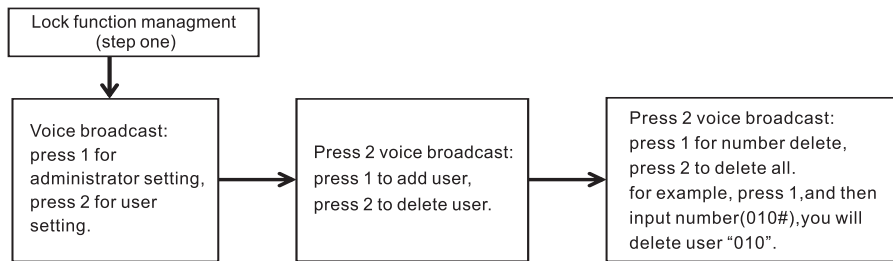

6. system setting

1) Voice setting

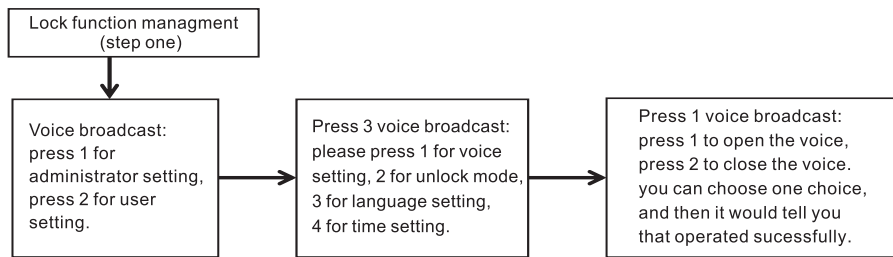

2) Unlock mode setting

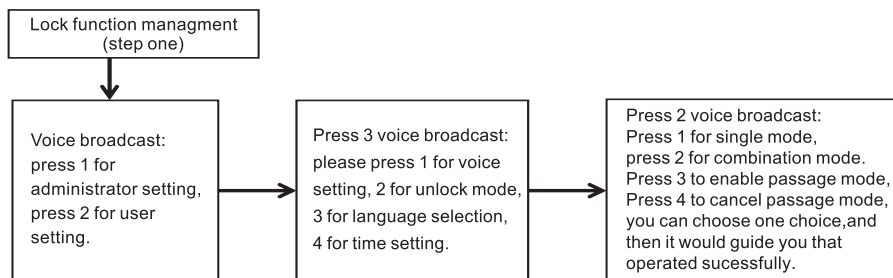

3) Language settings

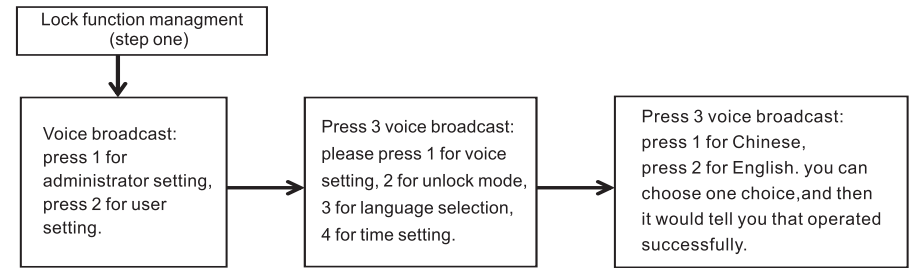

4) Time setting

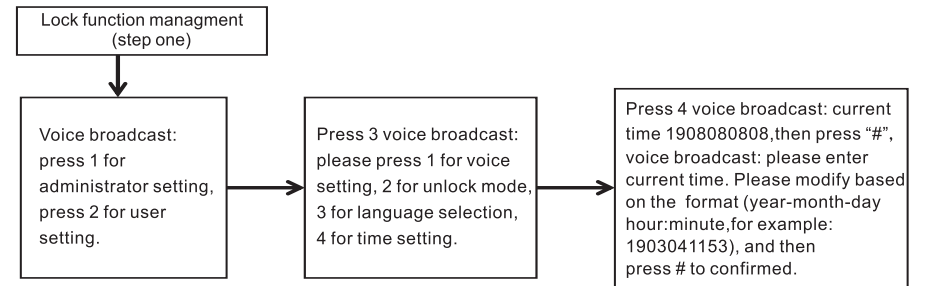

7. Restore factory settings

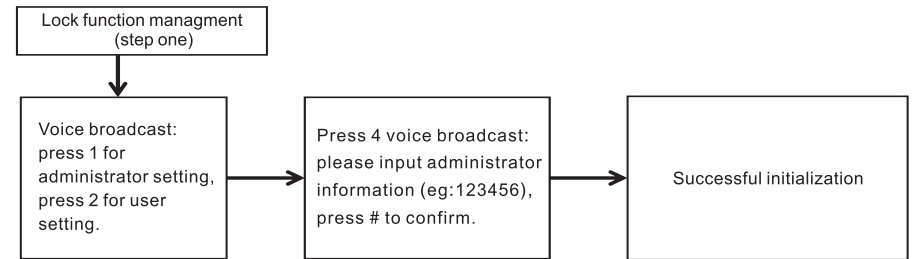

8. Add one network

1) Press "*" + "#" to authenticate administrator identity and then press "1" to access administrator settings. Then there will be a voice prompt of pressing "3" for network configuration.

Smart lock operation

▲ Initialization Settings

Please note: Before you can start using this lock, you must register a new administrator.

