

图片

PICTURE

M30x1.5, L73



CE

M30x1.5, L73



CE

直流-3线/DC-3 wires NPN N.O.	IBT30-LS15NA-D4YV1	* 29	IBT30-LN25NA-D4YV1	* 29
直流-3线/DC-3 wires NPN N.C.	IBT30-LS15NB-D4YV1	* 30	IBT30-LN25NB-D4YV1	* 30
直流-3线/DC-3 wires PNP N.O.	IBT30-LS15PA-D4YV1	* 31	IBT30-LN25PA-D4YV1	* 31
直流-3线/DC-3 wires PNP N.C.	IBT30-LS15PB-D4YV1	* 32	IBT30-LN25PB-D4YV1	* 32
直流-2线/DC-2 wires N.O.	IBT30-LS15LA-D4YV1	* 37	IBT30-LN25LA-D4YV1	* 37
直流-2线/DC-2 wires N.C.	IBT30-LS15LB-D4YV1	* 38	IBT30-LN25LB-D4YV1	* 38
检测距离/ Rated sensing distance	15mm		25mm	
安装方式/Mounting	埋入/shield		非埋入/non-shield	
工作电压/Supply voltage	DC12...24V (10...30V DC) 允许波动10%以下/ripple(p-p):10% max.			
漏电流/Leakage current	3线式/3 wires : <0.01mA(2线式/2 wires: <0.8mA)			
设定距离/Setting distance	0...12mm		0...20mm	
标准检出物体/Sensing target	铁/iron 45x45x1mm		铁/iron 75x75x1mm	
工作频率/Frequency	300Hz		200Hz	
消耗电流/Consumption	≤15mA			
负载电流/Load current	200mA			
电压降/Voltage drop(V _r)	≤1.8V(2线式: 负载电流100mA <5V)/≤1.8V(2 wires: Load current 100mA <5V)			
滞后/Hysteresis	1...15%			
重复精度/Repeatability	≤5%			
LED 显示/Display	红色/Red LED			
保护/Protection Circuit	短路保护、反极性保护、过载保护/Short circuit protection, reversed polarity protection and overload protection			
工作温度/Operating temperature	-25...+70°C (未结露状态) / -25...+70°C(no condensation)			
抗冲击/Anti-impact	500m/s ² (50G) X、Y、Z、方向各10次/500m/s ² (50G) X、Y、Z direction, each 10 times			
抗震动/Anti-vibration	10...55Hz (振幅1.5mm) X、Y、Z、方向各2小时/10...55Hz(amplitude 1.5mm)X、Y、Z direction each 2 hours			
防护等级/Protection	IP67			
连接方式/Connection	M12插座式连接, 带LEDx4/M12 connector, LEDx4			
外壳材料/Housing material	黄铜镀镍/nickel-plated brass			
检测面材料/Sensing face material	PBT			

尺寸图

Dimensional drawing

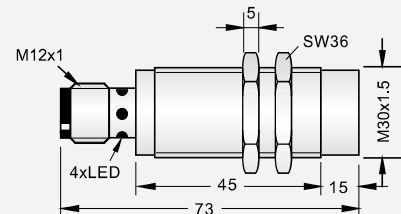
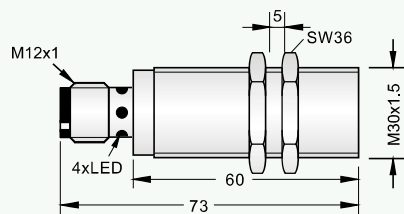

备注/Remark

注 1: *29, *30, *31, *32...表示接线图序号详见14...17页。