

---

Project Description

---

Video wall **VM55B-U**

## **VM55BU3x3**

- **Creator Name**

syscom

- **Project ID**

syscom

- **Customer Name**

syscom

\* The configuration information in this document is for simulated installation only, while actual physical specifications may vary. Please consult with Samsung or your installation partner for accurate information.

\* Specifications are subject to change without notice.

Date of configuration : 6th April, 2026



Samsung's VHR-R, VMB-R, VHB-E, VMB-E, VMB-U series video wall displays provide a captivating viewing experience for a wide variety of business settings. The displays' exceptionally slim depth, continuous operation capability and IP5X certification provide endless possibilities for retail stores, office spaces, public spaces and more. Built to operate all day, Samsung's video walls ensure businesses have an effective communication channel, even after traditional business hours. With wide viewing angles and special anti-glare panels Samsung's video wall display demands attention, even with bright ambient light, ensuring every word and image is as legible as it is impressive.

Video wall Configuration Rendering

Video wall **VM55B-U**

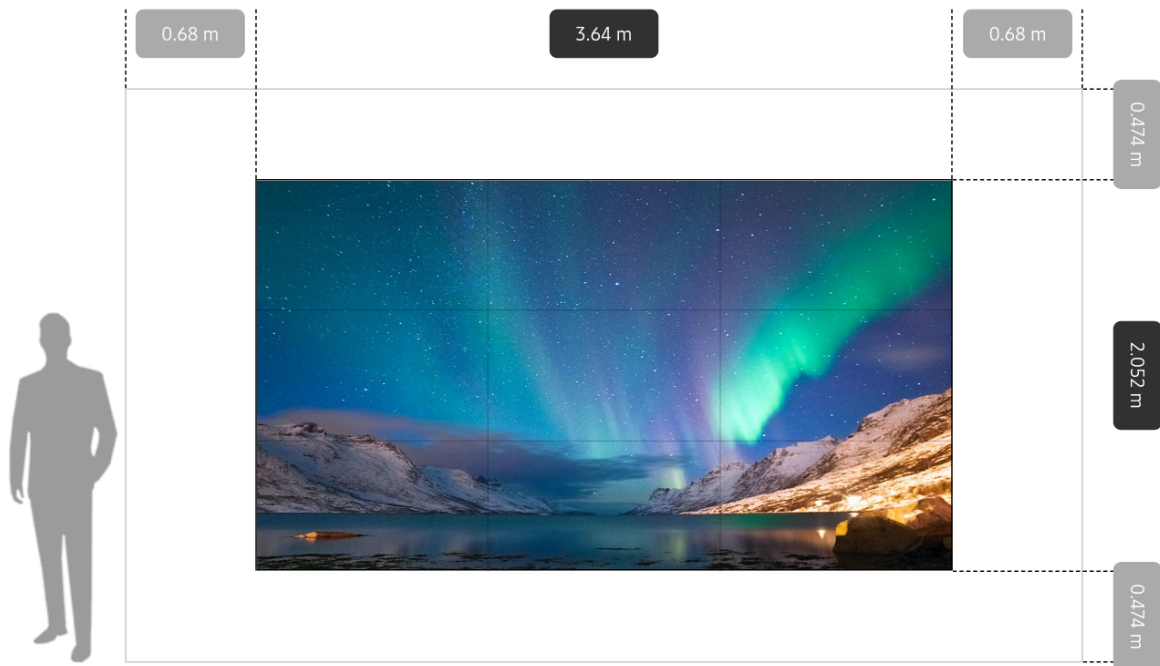

---

Screen Specifications

---

Model Name **VM55B-U**

Screen Configuration	Length x Height	3 Units x 3 Units
	Total No. of Screens	9 Units
Screen Specifications	Length x Height X Depth	3.64 x 2.052 x 0.073 m
	Diagonal	164.509 inch
	Weight	174.6 Kg
Power Requirements	Max	1980 (W/h)
	Typical	1485 (W/h)

Product Specification

Model Name **VM55B-U**

Display Panel	Diagonal size	55"
	Resolution	1920*1080 (Full HD)
	Brightness(Typ.)	500 nit
	Haze	25%
	Contrast Ratio (Typ.)	1200:1
	Type	IPS
	Active Display Area	1209.6(H) x 680.4(V)
	Pixel Pitch (mm)	0.63 x 0.63 mm
	Color Gamut	72%
	Operation Hour	24/7
Connectivity / Sound	Input(Video)	HDMI 2.0 (2) /DVI-D, Display Port 1.2
	Input(Audio)	Stereo mini Jack
	Input(USB)	USB 2.0 x 1
	Output(Video)	DP1.2(Loop-out)
	Output(Audio)	Stereo mini Jack
	EXTERNAL CONTROL	RS232C(in/out), RJ45 in
	Speaker	N/A
Mechanical Spec	Dimension (mm) - Set	1213.5 x 684.3 x 73.13 mm
	Dimension (mm) - Package	1398 x 844 x 257 mm
	Weight (kg) - Set	19.4 kg
	Weight (kg) - Package	27.6 kg
	VESA Mount	600 x 400
	Bezel Width (mm)	2.25mm(U/L), 1.25mm(R/B)
Power	Power Supply	AC 100 - 240 V, 50/60 Hz
	Power Consumption - Max[W/h]	220
	Power Consumption - Typical[W/h]	165
	Power Consumption - Sleep mode	less than 0.5W

---

**Product Specification**

---

Operating Condition	Temperature	0°C ~40°C
	Relative Humidity	10% ~80%

Production Information

## An immersive viewing experience for any business

Samsung's VHR-R, VMB-R, VHB-E, VMB-E, VMB-U series video wall displays provide a captivating viewing experience for a wide variety of business settings. The displays' exceptionally slim depth, continuous operation capability and IP5X certification provide endless possibilities for retail stores, office spaces, public spaces and more. Built to operate all day, Samsung's video walls ensure businesses have an effective communication channel, even after traditional business hours. With wide viewing angles and special anti-glare panels Samsung's video wall display demands attention, even with bright ambient light, ensuring every word and image is as legible as it is impressive.

## Why use Samsung's video wall displays for your business?



### Fit for any environment

The displays' slim depth gives businesses ultimate flexibility in creating a video wall that is perfectly suited to their needs and can be implemented in any location. IP5X certification ensures the display is completely dust resistant and can deliver a dependable viewing experience in a wide range of conditions. It also allows for video wall installation in public spaces without the need for additional dust-resistant molding.

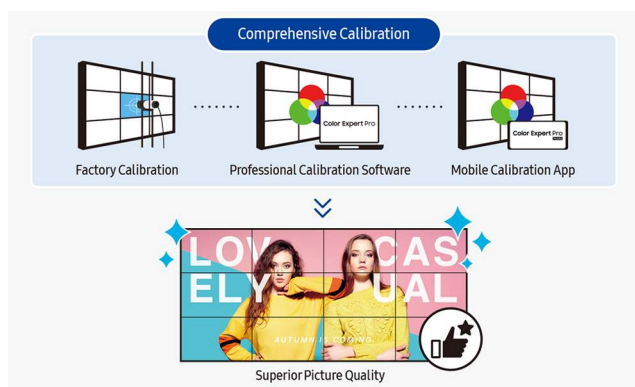

### Flawless uniformity

To ensure outstanding picture quality, all Samsung video wall displays are fine-tuned with a strict multi-step calibration process. Users may also adjust detailed settings to suit their individual needs using Samsung's free powerful software, Color Expert Pro. For businesses needing a simpler solution, Color Expert Pro Mobile makes for quick and easy calibration using a mobile device camera.

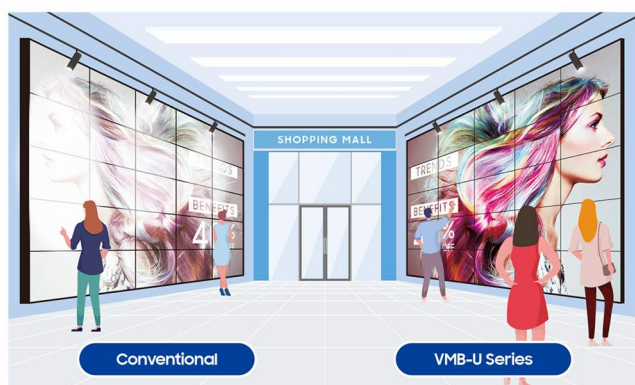

### Vivid viewing in any location

Samsung video walls feature wide viewing angles allowing viewers to see vivid content from any position. It eliminates potential distortion, ensuring colors, logos, fonts and messages are aligned with business' brand guidelines. Additionally, special anti-glare panels maintain vibrant and accurate visuals, preventing any disruption from bright lights, sunlight or glare any time of the day or night.

Production Information

### Samsung's lineup of video wall displays

Every business has different needs, which is why Samsung provides a range of video wall options with various levels of brightness, bezel widths and cabinet depths. Every one of our video wall models are guaranteed to deliver the vivid picture quality and reliable performance Samsung is known for. Additionally, all of our displays are easy to install, further reducing complexity for business owners.



	Razor narrow bezel		Extreme narrow bezel		Ultra narrow bezel
 Series	 <b>VHR-R Series</b>	 <b>VMB-R Series</b>	 <b>VHB-E Series</b>	 <b>VMB-E Series</b>	 <b>VMB-U Series</b>
 B-to-B Width	0.88mm	0.88mm	1.74mm	1.74mm	3.5mm
 Brightness	700 nit	500 nit	700 nit	500 nit	500 nit
 Depth	69.9mm	69.9mm	70.4mm	70.4mm	69.9mm (46") / 73.1mm (55")
 Viewing Angle (Vertical / Horizontal)	178° / 178°	178° / 178°	178° / 178°	178° / 178°	178° / 178°
 Calibration	PC & Mobile supported	PC & Mobile supported	PC & Mobile supported	PC & Mobile supported	PC & Mobile supported
 Other Keywords	IP5X ISTA-6A -	IP5X ISTA-6A -	IP5X — ISTA-3A -	IP5X ISTA-3A -	IP5X ISTA-6A Center IR

\* B-to-B means "Panel Bezel to Panel Bezel".

\* "Active area to Active area" may vary depending on the model and actual installation environment.

Production Information

Key features

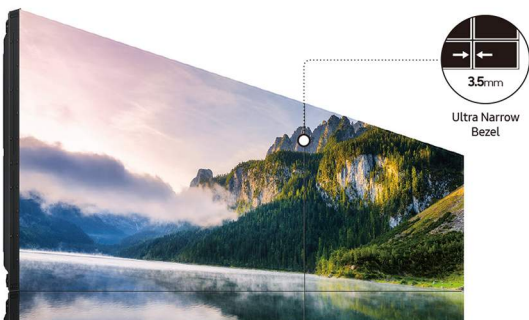

Captivate audiences through a narrow Bezel

A razor-narrow 0.88mm\* bezel-to-bezel design creates an uninterrupted visual experience across multiple screens. Minimizing the visual distraction of the screens themselves, the displays present a single, uniform picture that captures attention and keeps viewers focused on featured messages.

\* Bezel width varies by video wall model.



Adaptable slender design

The exceptionally thin 69.9mm\* cabinet depth provides businesses with more flexibility to create the exact video wall they need and install it in the most impactful location. The thoughtful design blends in seamlessly and transforms any location with powerful visuals.

\* Exact cabinet depth varies by video wall model.



View content from any angle

Wide viewing angles mean content is easily visible even if viewers aren't standing directly in front of the display. Audiences can get clear details and vivid colors regardless of where the screen is located.

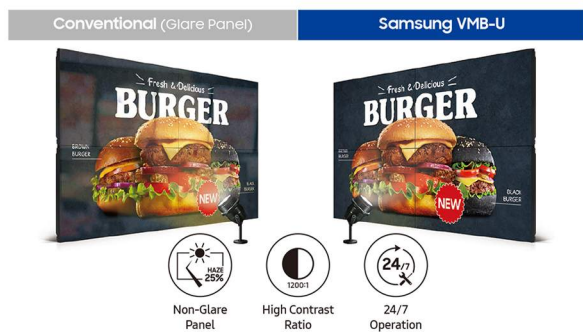

Vibrant images in any light

Non-glare panels evenly distribute light across the screen to maintain vibrant and accurate content. Combined with a high contrast ratio and 24/7 operation, visuals are vivid and eye-catching any time of the day or night — regardless of ambient light.



Image enhancement

Samsung's powerful picture enhancement technology ensures all content is vibrant and clear. With Picture Enhancer mode, color saturation and contrast are improved by adjusting the gamma curve. Using Black Equalizer mode, dark images are lightened, making details easier to see.

Production Information

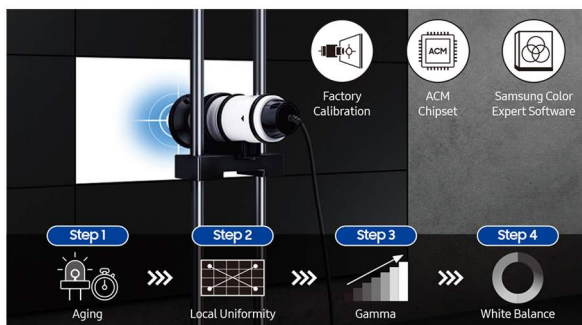

**Comprehensive calibration**

Multi-step factory calibration process tunes video walls to uniform brightness and color throughout multiple displays. In addition to rigorous factory calibration, users can also manage brightness and color uniformity with Samsung's Color Expert Pro, a powerful free software program.

\* Local uniformity (Step 2) and ACM chipset support vary by model.



**Convenient mobile calibration**

For users who seek quick and simple video wall settings, Samsung's Color Expert Pro Mobile enables an easy video wall calibration using a mobile camera. With the solution's intuitive UI, even non-expert users can adjust up to 3x3 video wall's white balance simultaneously without the need for additional equipment.



**Built durable and user-friendly**

IP5x certified, Samsung video walls are dust-resistant and able to withstand a range of environmental conditions without needing to prepare additional enclosure in dusty places. An embedded, centrally located infrared receiver (IR)\* allows for easier and more flexible user control.

\* Center IR support varies by each video wall model.



**Advanced presentation, simplified operation**

Utilizing daisy chain design through DisplayPort 1.2 or HDMI ports enable Samsung video wall displays to present UHD content on multiple screens without an external graphic card. Samsung's UHD Signage Player Box streamlines functionality by combining the media player and content management software.

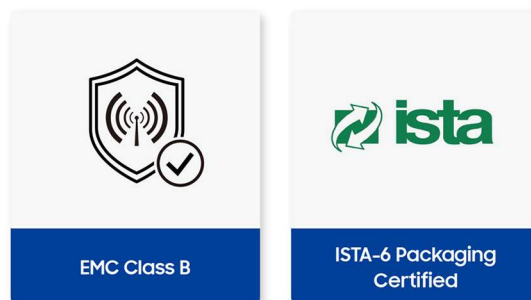

**Industry standard certified**

Samsung's video wall displays are EMC class B compliant\*, which ensures a safe viewing environment by meeting strict standards of electromagnetic wave emission. The display packaging also underwent a rigorous ISTA lab 4-step test and is designed to minimize possible damage during delivery.

Production Information

Business applications



Production Information

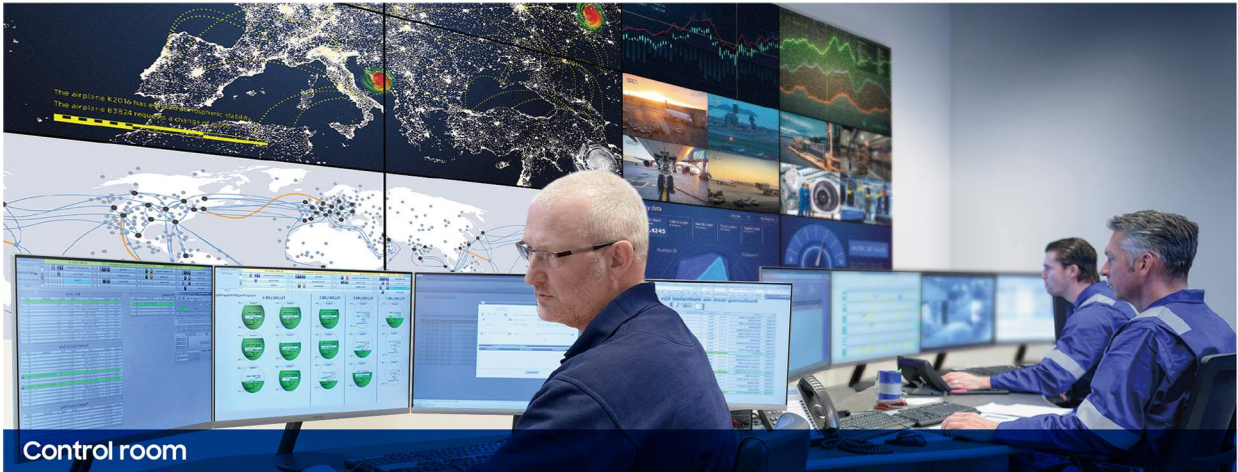

Control room



Museum

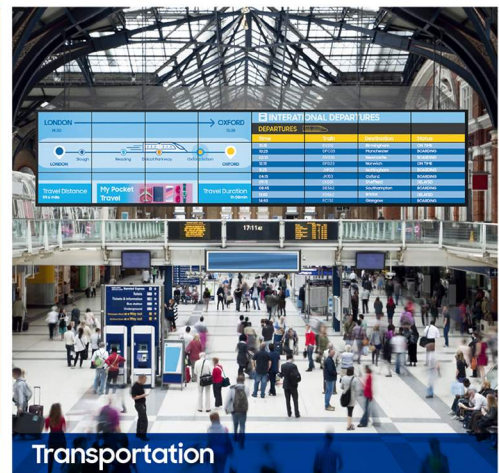

Transportation



Retail

Production Information

Specifications

Model			VH55R-R	VM55B-R
Display Panel	Diagonal Size	Class	55"	55"
	Measured		54.6" / 138.7cm	54.6" / 138.7cm
	Resolution		1920x1080(16:9)	1920x1080(16:9)
	Brightness(Typ.)		700nit	500nit
	Orientation		Landscape / Portrait	Landscape / Portrait
	Haze		28%	28%
	Contrast Ratio (Typ.)		1100:1	1100:1
	Type		IPS	IPS
	Active Display Area		1209.6(H) x 680.4(V)	1209.6(H) x 680.3(V)
	Pixel Pitch (mm)		0.63x0.63	0.63x0.63
	Color Gamut		72	72
Operation Hour		24/7	24/7	
Connectivity / Sound	INPUT	VIDEO	HDMI 2.0 (2), DVI-D, Display Port 1.2	HDMI 2.0 (2), DVI-D, Display Port 1.2
		AUDIO	Stereo mini Jack	Stereo mini Jack
		USB	Only F/W upgrade	Only F/W upgrade
		Tuner	N/A	N/A
	OUTPUT	VIDEO	DP1.2(Loop-out)	DP1.2(Loop-out)
		AUDIO	Stereo mini Jack	Stereo mini Jack
		USB	N/A	N/A
	WIFI / BT		N/A	N/A
EXTERNAL CONTROL		RS232C(in/out), RJ45	RS232C(in/out), RJ45 in	
Speaker		N/A	N/A	
Mechanical Spec	Dimension (mm)	Set	1211.0 x 681.7 x 69.9	1211.0 x 681.7 x 69.9
		Package	1414.0 x 844.0 x 257.0	1414 x 844 x 257
	Weight (kg)	Set	16.8	16.8
		Package	25.1	25.1
	VESA Mount		600 x 400	600 x 400
Bezel Width (mm)		0.44mm(even)	0.44mm(even)	
Features	Internal Player	Operating System	N/A	N/A
		Processor	N/A	N/A
		Storage (FDM)	N/A	N/A
	Special	H/W	ACM Support(Advanced Color Management) Temperature Sensor Video Wall Daisy Chain(10x10) DP1.2 Digital Daisy Chain(Supporting UHD Resolution, HDCP support) Clock Battery(168hrs Clock Keeping)	ACM Support(Advanced Color Management) Temperature Sensor Video Wall Daisy Chain(10x10) DP1.2 Digital Daisy Chain(Supporting UHD Resolution, HDCP support) Clock Battery(168hrs Clock Keeping)
		S/W	Auto Source Switching & Recovery RS232C/RJ45 MDC Button Lock Smart F/W update	Auto Source Switching & Recovery RS232C/RJ45 MDC Button Lock Smart F/W update
Certification	Safety		60950-1	60950-1
	EMC		Class B	Class A
	Environment		N/A	N/A
	IP Rating		IP5x	IP5x
	Security		N/A	N/A
Power	Power Supply		AC 100 - 240 V~, 50/60 Hz	AC 100 - 240 V, 50/60 Hz
	Power Consumption	Max[W/h]	270	270
		Typical[W/h]	153	165
		Sleep mode	less than 0.5W	less than 0.5W
Operating Condition	Temperature		0°C - 40°C	0°C - 40°C
	Relative Humidity		10~80%	10~80%
Accessories	Included		Quick Setup Guide Warranty Card Power Cord RS232C(IN) Gender (Stereo to DB-9) Remote Controller + Batteries DP cable	Quick Setup Guide Warranty Card Power Cord RS232C(IN) Gender (Stereo to DB-9) Remote Controller + Batteries DP cable
	Optional	Stand	N/A	N/A
		Mount	WMN-55VD	WMN-55VD
		Specialty	N/A	N/A

Production Information

Model			VH55B-E	VM55B-E
Display Panel	Diagonal Size	Class	55"	55"
	Measured		54.6" / 138.7cm	54.6" / 138.7cm
	Resolution		1920x1080(16:9)	1920x1080(16:9)
	Brightness(Typ.)		700nit	500nit
	Orientation		Landscape / Portrait	Landscape / Portrait
	Haze		28%	28%
	Contrast Ratio (Typ.)		1000:1	1000:1
	Type		IPS	IPS
	Active Display Area		1209.6(H) x 680.4(V)	1209.6(H) x 680.4(V)
	Pixel Pitch (mm)		0.63x0.63	0.63x0.63
Color Gamut		72	72	
Operation Hour		24/7	24/7	
Connectivity / Sound	INPUT	VIDEO	HDMI 2.0 (2), DVI-D, Display Port 1.2	HDMI 2.0 (2), DVI-D, Display Port 1.2
		AUDIO	Stereo mini Jack	Stereo mini Jack
		USB	Only F/W upgrade	USB 2.0 x1
		Tuner	N/A	N/A
	OUTPUT	VIDEO	DP1.2(Loop-out)	DP1.2(Loop-out)
		AUDIO	Stereo mini Jack	Stereo mini Jack
		USB	N/A	N/A
	WIFI / BT		N/A	N/A
EXTERNAL CONTROL		RS232C(in/out), RJ45	RS232C(in/out), RJ45 in	
Speaker		N/A	N/A	
Mechanical Spec	Dimension (mm)	Set	1212.2 x 683 x 70.4	1212.2 x 683 x 70.4
		Package	1398 x 844 257	1398 x 844 257
	Weight (kg)	Set	19.5	19.5
		Package	28.6	28.6
	VESA Mount		600 x 400	600 x 400
Bezel Width (mm)		B2B : 1.74mm (Panel Bezel to Panel Bezel), 1.3mm(U/L), 0.44mm(R/B) A2A : 2.49mm (Active area to Active area), 1.75mm(U/L), 0.74mm(R/B)	B2B : 1.74mm (Panel Bezel to Panel Bezel), 1.3mm(U/L), 0.44mm(R/B) A2A : 2.49mm (Active area to Active area), 1.75mm(U/L), 0.74mm(R/B)	
Features	Internal Player	Operating System	N/A	N/A
		Processor	N/A	N/A
		Storage (FDM)	N/A	N/A
	Special	H/W	ACM Support(Advanced Color Management) Temperature Sensor Video Wall Daisy Chain(10x10) DP1.2 Digital Daisy Chain(Supporting UHD Resolution, HDCP support) Clock Battery(168hrs Clock Keeping)	ACM Support(Advanced Color Management) Temperature Sensor Video Wall Daisy Chain(10x10) DP1.2 Digital Daisy Chain(Supporting UHD Resolution, HDCP support) Clock Battery(168hrs Clock Keeping)
S/W		Auto Source Switching & Recovery RS232C/RJ45 MDC Button Lock Smart F/W update	Auto Source Switching & Recovery RS232C/RJ45 MDC Button Lock Smart F/W update	
Certification	Safety		60950-1	60950-1
	EMC		Class B	Class B
	Environment		N/A	N/A
	IP Rating		IP5x	IP5x
	Security		N/A	N/A
Power	Power Supply		AC 100 - 240 V, 50/60 Hz	AC 100 - 240 V, 50/60 Hz
	Power Consumption	Max[W/h]	250	220
		Typical[W/h]	186	133
		Sleep mode	less than 0.5W	less than 0.5W
Operating Condition	Temperature		0°C~ 40°C	0°C~ 40°C
	Relative Humidity		10~80%	10~80%
Accessories	Included		Quick Setup Guide Warranty Card Power Cord RS232C(IN) Gender (Stereo to DB-9) Remote Controller + Batteries DP cable	Quick Setup Guide Warranty Card Power Cord RS232C(IN) Gender (Stereo to DB-9) Remote Controller + Batteries DP cable
	Optional	Stand	N/A	N/A
		Mount	WMN-55VD	WMN-55VD
		Specialty	N/A	N/A

Production Information

Specifications

Model			VM46B-U	VM55B-U
Display Panel	Diagonal Size	Class	46"	55"
		Measured	45.9"/116.8cm	54.6"/138.7cm
		Resolution	1920x1080(16:9)	1920x1080(16:9)
		Brightness(Typ.)	500nit	500nit
		Orientation	Landscape / Portrait	Landscape / Portrait
		Haze	25%	25%
		Contrast Ratio (Typ.)	1200:1	1200:1
		Type	IPS	IPS
		Active Display Area	1018.08(H) x 572.6(V)	1209.6(H) x 680.4(V)
		Pixel Pitch (mm)	0.53x0.53	0.63x0.63
	Color Gamut	72	72	
	Operation Hour	24/7	24/7	
Connectivity / Sound	INPUT	VIDEO	HDMI 2.0 (2), DVI-D, Display Port 1.2	HDMI 2.0 (2), DVI-D, Display Port 1.2
		AUDIO	Stereo mini Jack	Stereo mini Jack
		USB	Only F/W upgrade	Only F/W upgrade
		Tuner	N/A	N/A
	OUTPUT	VIDEO	DP1.2(Loop-out)	DP1.2(Loop-out)
		AUDIO	Stereo mini Jack	Stereo mini Jack
		USB	N/A	N/A
		WiFi / BT	N/A	N/A
		EXTERNAL CONTROL	RS232C(in/out), RJ45 in	RS232C(in/out), RJ45 in
	Speaker	N/A	N/A	
Mechanical Spec	Dimension (mm)	Set	1022 x 577 x 69.9	1213.5 x 684.3 x 73.13
		Package	1193 x 719 x 257	1398 x 844 x 257
	Weight (kg)	Set	15.7	19.4
		Package	22.2	27.6
		VESA Mount	600 x 400	600 x 400
		Bezel Width (mm)	2.25mm(U/L), 1.25mm(R/B)	2.25mm(U/L), 1.25mm(R/B)
Features	Internal Player	Operating System	N/A	N/A
		Processor	N/A	N/A
		Storage (FDM)	N/A	N/A
	Special	H/W	Temperature Sensor Video Wall Daisy Chain(10x10) DP1.2 Digital Daisy Chain(Supporting UHD Resolution, HDCP support) Clock Battery(168hrs Clock Keeping)	Temperature Sensor Video Wall Daisy Chain(10x10) DP1.2 Digital Daisy Chain(Supporting UHD Resolution, HDCP support) Clock Battery(168hrs Clock Keeping)
		S/W	Auto Source Switching & Recovery RS232C/RJ45 MDC Button Lock Smart F/W update	Auto Source Switching & Recovery RS232C/RJ45 MDC Button Lock Smart F/W update
	Certification	Safety		60950-1
EMC		Class A	Class A	
Environment		N/A	N/A	
IP Rating		IP5x	IP5x	
Security		N/A	N/A	
Power	Power Supply		AC100 - 240 V, 50/60 Hz	AC100 - 240 V, 50/60 Hz
	Power Consumption	Max[W/h]	160	220
		Typical[W/h]	128	165
		Sleep mode	less than 0.5W	less than 0.5W
Operating Condition	Temperature		0°C- 40°C	0°C- 40°C
	Relative Humidity		10~80%	10~80%
Accessories	Included		Quick Setup Guide Warranty Card Power Cord RS232C(IN) Gender (Stereo to DB-9) Remote Controller + Batteries DP cable	Quick Setup Guide Warranty Card Power Cord RS232C(IN) Gender (Stereo to DB-9) Remote Controller + Batteries DP cable
	Optional	Stand	N/A	N/A
		Mount	WMN-46VD	WMN-55VD
		Specialty	N/A	N/A

---

Production Information

---



**VM55B-U**